

U BLOCK | EVENTS SPACE

U BLOCK

THE
TRUMAN
BREWERY

U BLOCK | EVENTS SPACE



EVENTS



FASHION
SHOWS



MARKETS



PARTIES



EXHIBITIONS



LICENSED

ABOUT

U Block is a repurposed warehouse set back from Brick Lane. This blank canvas event space benefits from a high sloped ceiling from 6.5m to 4.5m, polished concrete flooring and no pillars offering maximum flexibility for all event types. The space well suited for large set builds, fashion shows and film screenings as well as pop up markets, product launches and exhibitions.

ACCESS

Guest access is via Brick Lane.
Loading access is via Brick Lane Yard to the rear of the building.

ADDRESS

By 148 Brick Lane, London, E1 6QL

CAPACITY

600

SIZE

7,621 sqft

LEVEL

Street level

CEILING HEIGHT

Sloped Ceiling with height under beam 6.5m to 4.5m

U BLOCK | EVENTS SPACE



LOCATION

U Block is located on the east side of the Truman Brewery Estate, on Brick Lane. In one of London's most vibrant and energetic areas, known throughout London, the iconic Truman chimney and ever-active Estate is frequented by media, creative, fashion and tech industry denizens. The area attracts many thousands of visitors to the bustling work spaces, themed events, weekend markets, eye-popping street art, boutiques, cafes and rich diversity of restaurants.

SERVICES

The space is serviced by 3 sets of roller shutters, one on Brick Lane, one to the rear of the building, and one to the side of the building opening to Brick Lane Yard. 2 x male toilets plus urinals, and 5 x female toilets.

COMMS

The Truman Brewery's dedicated on-site service provider, TruTec Services, can easily provide support, networking, telephony and internet connectivity to this location.

POWER

Main Distribution Board:

1 x 32A 3 Phase C Form Socket.

1 x 16A Single Phase C Form Socket.

1 x 63A 3 Phase C Form Socket (Max 50A).

4 x 32A Single Phase C Form Socket (at high level).

Commando Distribution Board:

1 x 63A 3 Phase C Form Socket.

11 x 32A Single Phase C Form Socket.

Sub Distribution Board (Fed from Commando):

9 x 32A Single Phase C Form Socket.

Twin 13A Sockets throughout.

LIGHTING

Strip Lights.

SUPPLIERS

We recommend the use of the following teams:

EVENT PRODUCTION:

E1 PRODUCTIONS

INTERNET CONNECTIVITY:

TRU TEC SERVICES

SECURITY:

Trusec Security Ltd.
Event Security Services

EVENT CLEANING SERVICES:

The Truman Brewery
Event Cleaning Services





THE TRUMAN BREWERY

A: 91 Brick Lane, London E1 6QL
 T: 0207 770 6011
 E: monika@trumanbrewery.com

DRAWING NAME

U.GND

SPACE DETAILS

U BLOCK
 GROUND FLOOR
 BASIC PLAN

VENUE LOCATION

U block
 91 Brick Lane
 Brick Lane Yard
 London E1

LEASE AREA (WITHIN RED BOUNDARY)

7621 SQ FT

SCALE

1:220 @ A4

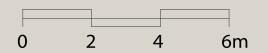

NOTES

1234 CEILING HEIGHTS
 GIVEN IN MILLIMETRES
 ROUNDED DOWN

All measurements are approximate.
 Measurements in millimetres.

DO NOT SCALE.
 IF IN DOUBT ASK.

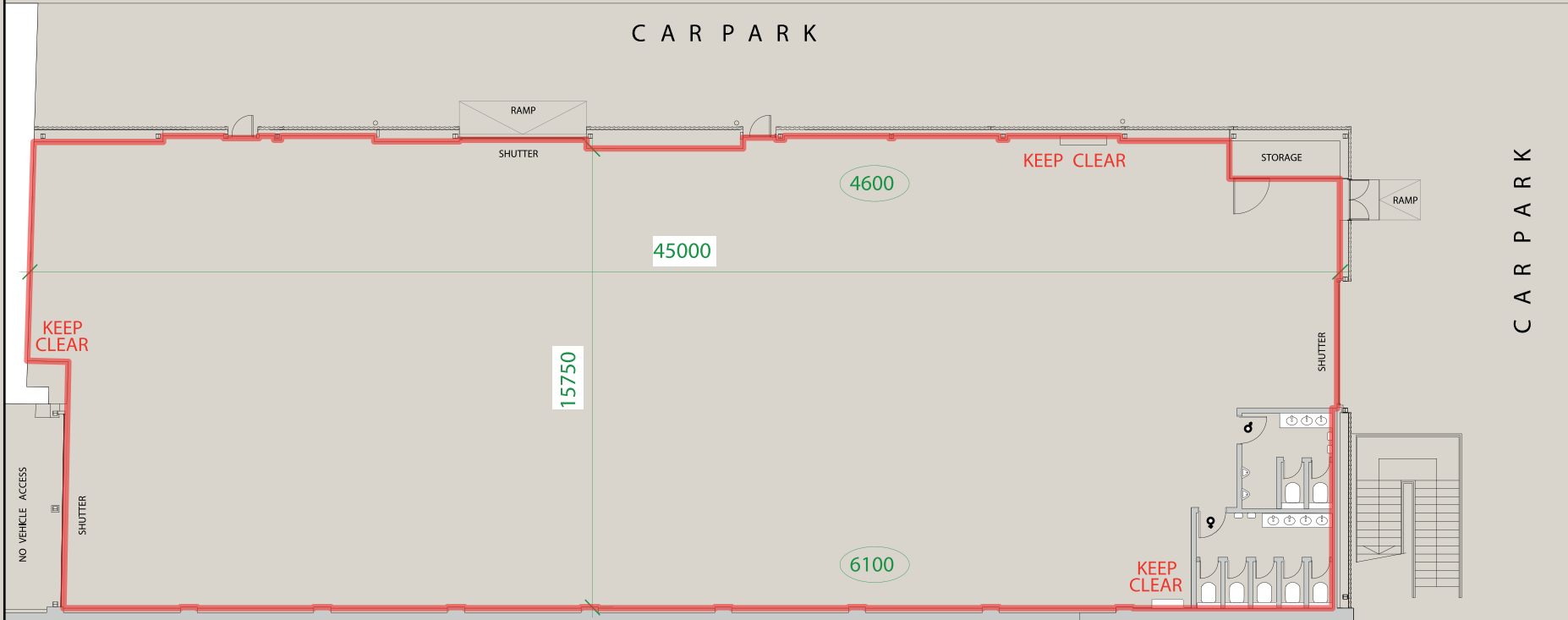

C A R P A R K

Coca-Cola
SIGNATURE MIXERS



TRANSPORT

U Block and The Truman Brewery have probably the most central Shoreditch location, and are easily reached by bus, rail, tube or on foot.

The venue benefits from close access to all forms of public transport. Liverpool Street and Shoreditch High Street stations are a short distance away, with Aldgate East within easy reach, offering fast connections across London and beyond.

Liverpool Street Station
Walking distance: 10 min

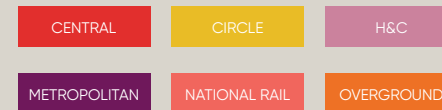

Shoreditch High Street Station
Walking distance: 5 min



Aldgate East Station
Walking distance: 10 min



Whitechapel Station
Walking distance: 15 min



Contact us to arrange a viewing:

Phone

+44(0)20 7770 6001

Email

events@trumanbrewery.com

Drop in

The Truman Brewery Events Department,
E y's Yard,
15 Hanbury Street,
London E1 6QR